

## Paper Production

We have designed various structures related to paper and cardboard production whether this is from printing to the production of corrugated cardboard.

Special consideration had to be given to the design of the structures and floors due to the high loading requirements at these buildings.



## Industrial General

Projects have included warehousing, chemical works and swarf handling facilities as well as items as diverse as pressure vessels and radio masts. We have provided solutions to problems of vibration in machinery and regularly provide designs to resist seismic loads and other less common load cases. We are able to apply an informed "basic principles" approach to unusual problems and always try to provide practical, imaginative and complete solutions from feasibility studies to fabrication details.



## Research & Development

Peter Dann endeavours to be at the forefront of research and development.

The work that is undertaken can be categorised into three main areas: modular structures, tented structures and software.



For further information please contact us:

**CAMBRIDGE**  
NEWTON HOUSE  
CAMBRIDGE ROAD  
BARTON  
CAMBRIDGE  
CB23 7WJ

T: 01223 264688  
F: 01223 264680

**LONDON**  
9 CHARLOTTE STREET  
LONDON  
W1T 1RG

T: 020 7637 7870  
F: 020 7637 7880

pd@peterdann.com  
www.peterdann.com

PETER DANN LIMITED | CONSULTING ENGINEERS

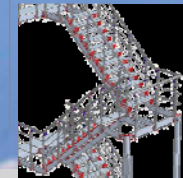
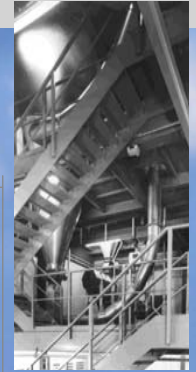
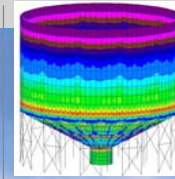

PETER DANN LIMITED

INDUSTRIAL

# Industrial...

## Human Food

Based in Cambridge Peter Dann has worked closely with the Human food industry. Our knowledge is based on the East Anglian food industry has provided a sound knowledge and reputation, which has led us to work on projects from India to Uganda.

We have worked on plants that have processed meat, vegetables, tea, Rice flours, breads, milk & alcoholic beverages.



## Pet Food

Our knowledge of the Human food process has bridged the gap to the pet food industry. We have worked on dry and wet food plants. The wet food plants have been designed for canned and pouched packaging.

We have experience designing structures to support various plants that are sensitive to vibration.

With our computer aided design we have planned sites in terms of lorry movements and logistics.



## Chemical

We have worked on many chemical and related plants in Great Britain and abroad. Using our solid modelling system we have designed and detailed, including the fabrication drawings for a chemical plant in America. This was designed to American codes using American steel sections.

We recently completed a chemical plant near Cambridge for the production of glues to be used in ship building.



## Animal Food

The other section of the food industry we have gained a great deal of experience in is the design of animal feed plants both mono-gastric and ruminant.

This experience includes the design of the building structures, bins, foundations and external works.

We have been responsible for projects from inception to completion, undertaking tasks ranging from project management to detailed analysis of the steel frame using solid modelling software.



## Agriculture

The Cambridge office situated in rural East Anglia has long been associated with the farming industry from the intervention stores for grain to bulk stores for onions and other vegetables.

We have recently completed large grain stores with ventilated floors for storing dried grain.

With computer aided design and detailing we are able to produce economical designs quickly and accurately.



## Tanks

With most industries there is a demand for the storage of materials in tanks, silos & flat stores.

Peter Dann have designed square, rectangular & round silos for the storage of feed products and materials. The rectangular have been panel twin skinned bins giving smooth surfaces designed to the latest Euro codes.

We have also designed large settling tanks for the mining industry. To achieve efficient design we have used finite element analysis software.

